

Ideas for chges to be made t the iAtty based on Users experiences. The two washers would allo the user replace the coils without having to unscrew the Delrin pieces

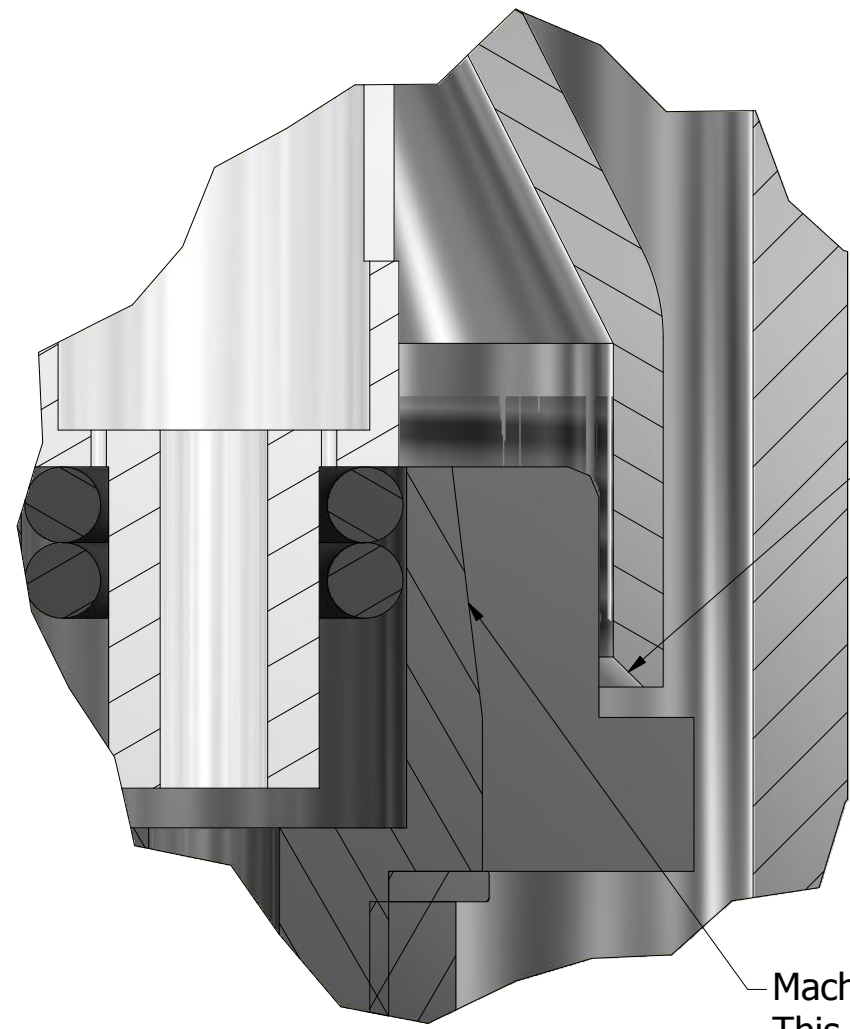

DETAIL A
SCALE 8 : 1

Place a 45° chamfer on the inside edge of the cone. This will help prevent the cone from cutting the wick

Machine a small taper in the slot of the Delrin. This will allow a little more spce in the slot for different size wicks. It will also provide a mechanism to gradually pinch down on the wick decreasing liquid flow

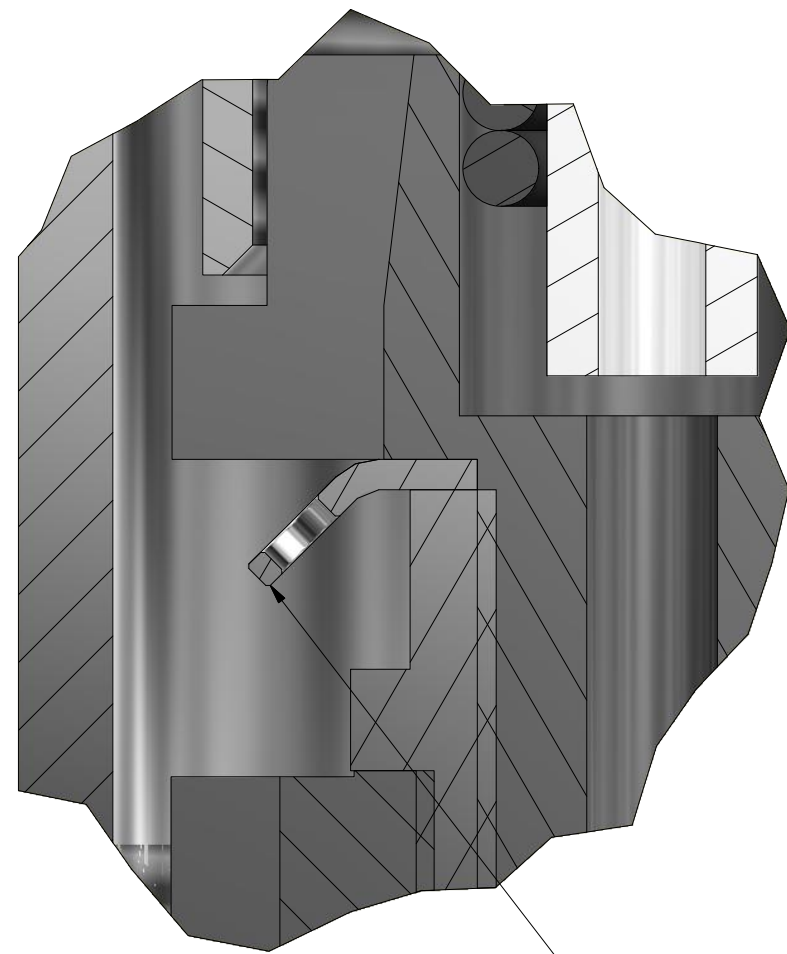

DETAIL B
SCALE 8 : 1

Create a new part. Basically a 0,5mm thick Washer with a small tang bent to a 45° angle. This tang has a 0,5 mm drilled into it. This tang allows you to thread the NR wre through it then tie it off.

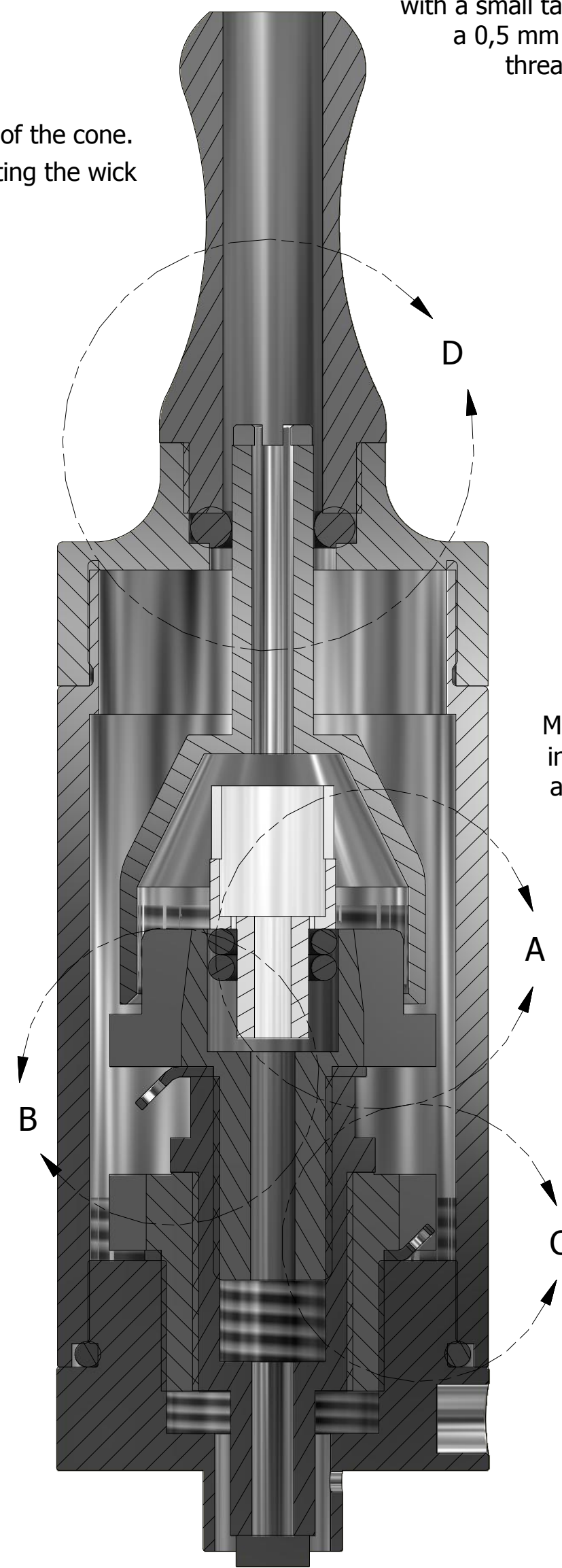

SECTION A-A
SCALE 4 : 1

Create a new part. Basically a 0,5mm thick Washer with a small tang bent to a 45° angle. This tang has a 0,5 mm drilled into it. This tang allows you to thread the NR wre through it then tie it off.

Machine two slots into the top of ste of the cone in the shape of an "X". This will allow the use of a Philips head jewelers screwriver to adjust the juice flow without having to reove either the Top Cap or the Mouthpiece.

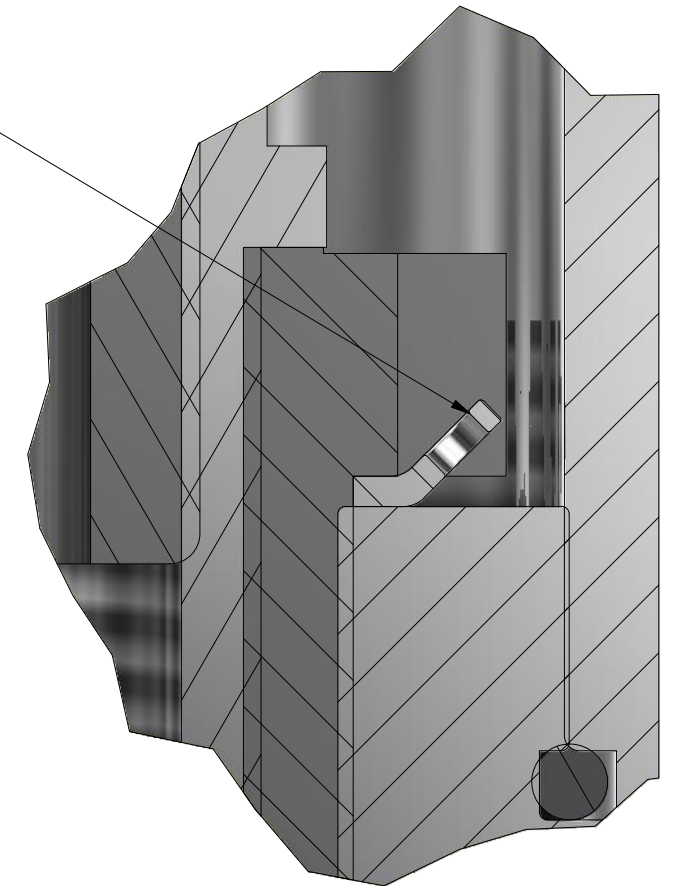

DETAIL C
SCALE 8 : 1

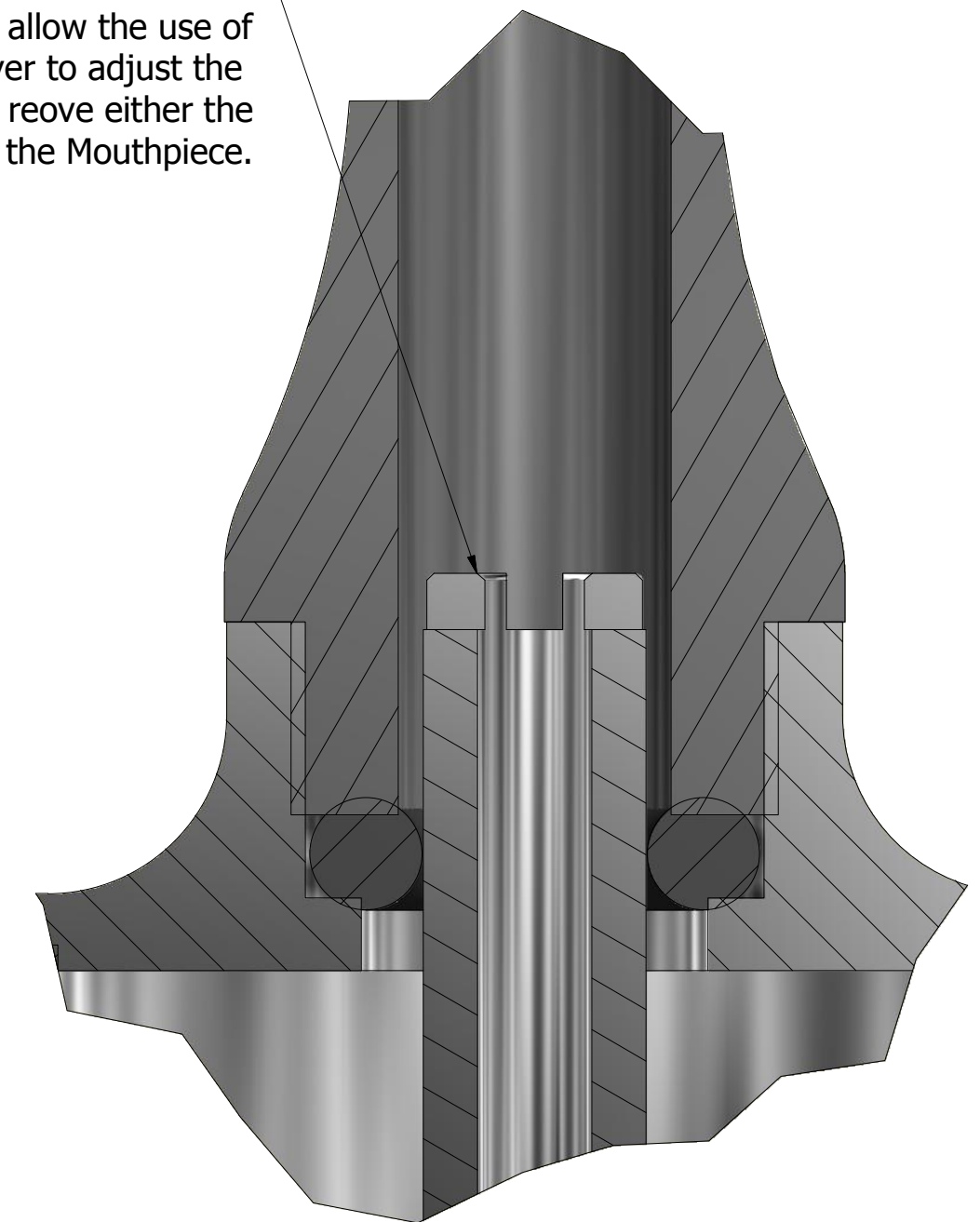

DETAIL D
SCALE 8 : 1